

THE WINDSOR

The Windsor provides the home purchaser with everything you need in a quality home.

With two floor plans which provides the option for an amazing alfresco area all under the roofline, protecting you and your furniture from the elements.

With four large bedrooms and an additional study, this homes provides comfortable living all within a cleverly designed floor plan. This large homes design utilises the space effectively and efficiently, ensuring you have it all when building your new home.

Ask our friendly consultants today for assistance in developing your dream home.



CHOOSE YOUR OWN FACADE



THE WINDSOR 200

Living: 199.42 m²
Garage: 40.25 m²
Porch: 2.40 m²
Total: 242.07 m²
Length: 19.65 m
Width: 18.45 m

Areas sq metres.

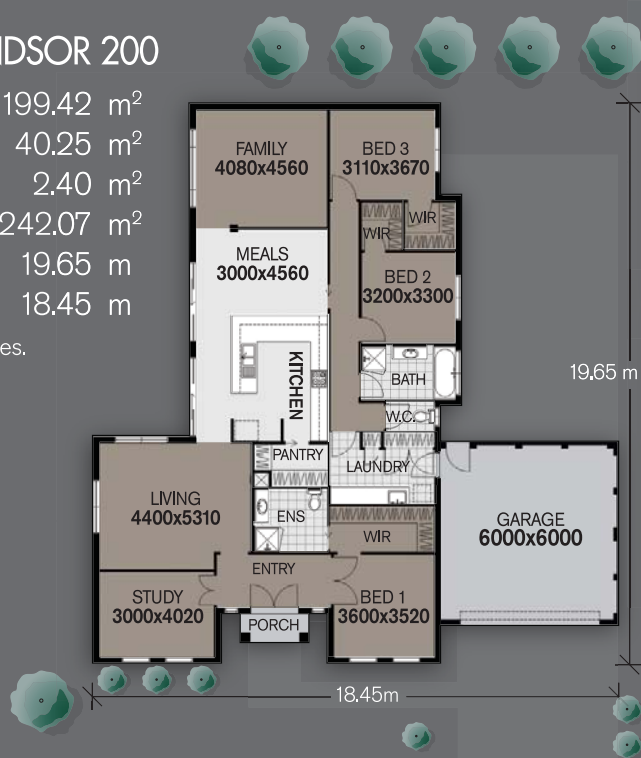

THE WINDSOR CLASSIC



THE WINDSOR COLONIAL

